

## **5 - TERMS OF THE WARRANTY :**

As the original purchaser of this equipment has purchased from Emaux Water Technology Co Ltd, through Authorized International Distributor or Dealer, warrants its products free from defects in materials and workmanship under normal use during the warranty period. The warranty period begins on the day of purchase and extends only to the original purchaser. It is not transferable to anyone who subsequently purchases the product from you. It excludes all expendable parts.

During the warranty period, Emaux authorized reseller will repair or replace defective parts with new parts or, at the option of Emaux, serviceable used parts that are equivalent or superior to new parts in performance.

This Limited Warranty extends only to products purchased from Emaux authorized resellers. This Limited Warranty does not extend to any product that has been damaged or rendered defective.

- (a) as a result of an accident, misuse, or abuse;
- (b) as a result of an act of God;
- (c) by operation outside the usage parameters stated herein;
- (d) by the use of parts not manufactured or sold by Emaux;
- (e) by modification of the product;
- (f) as a result of war or terrorist attack; or
- (g) as a result of service by anyone other than Emaux authorized reseller or authorized agent.

EXCEPT AS EXPRESSLY OUTLINED IN THIS WARRANTY, EMAUX MAKES NO OTHER WARRANTIES EXPRESSED OR IMPLIED, INCLUDING ANY IMPLIED WARRANTIES OF MERCHANTABILITY AND FITNESS FOR A PARTICULAR PURPOSE. EMAUX EXPRESSLY DISCLAIMS ALL WARRANTIES NOT STATED IN THIS LIMITED WARRANTY. ANY IMPLIED WARRANTIES THAT MAY BE IMPOSED BY LAW ARE LIMITED TO THE TERMS OF THIS EXPRESS LIMITED WARRANTY.

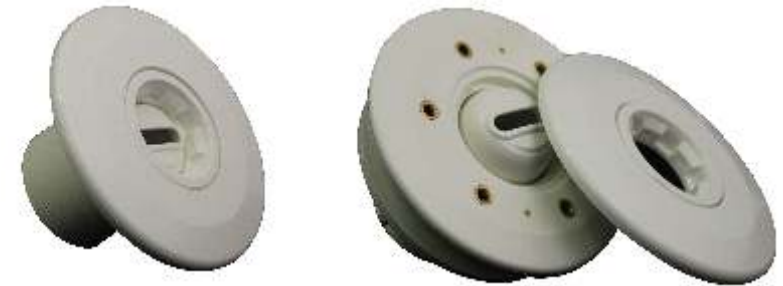

## **WALL RETURN INLETS**

### **MANUAL INSTALLATION .**

#### **MODELS :**

EM4411(A) / EM4411(E)  
EM4412(A) / EM4412(E)

## WALL RETURN INLETS

**IMPORTANT :** This instruction manual includes essential information on the safety measures to be implemented for installation and start up .Therefore ,the installer as well as the user must read the instructions before starting installation and start up .  
**Keep this manual for future reference**

### 1 .-WALL RETURN INLET :

Return inlets are one of the most important pool fittings for a proper water recirculation . Two different models of return inlets are available :Wall return and Floor return inlets. Wall return inlets are specially designed for those pools with skimmers ,since the water recirculation in the pool is "horizontal" from the inlets to the skimmers . On the other hand ,the Floor return inlets are recommended to be installed in swimming pools with overflow channel .They prevent dirt from settling by lifting it towards the overflow , creating a "vertical" recirculation .

### 2 .-INSTALLATION :

The positioning of the wall return inlets is important in order to obtain a proper water recirculation and avoid any zone in the pool where water is not circulated periodically. It is recommended to install the Wall return inlets in the opposite side of the skimmers, and 200 - 300mm depth from the water surface. (Fig.1)

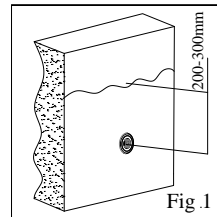

The flow rate required for the installation will determine the number of inlets needed Each Wall return inlet allows a water flow rate of 2 3 m<sup>3</sup> h . It is recommended to install the wall conduit model **EM2841** (for concrete pools )or **EM2842** (for Vinyl pools ).

### 3 .-MODELS :

Concrete pools (Fig 2 )	
EM4411	
Metrical connections	Pipe 50 mm or thread 2 "
Imperial connections	Pipe 1 1/2" or thread 2 "

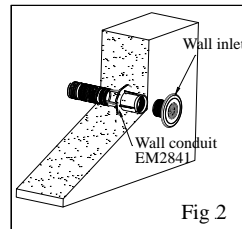

Vinyl pools with Liner (Fig 3 )	
EM4412	
Metrical connections	Pipe 50 mm or thread 2 "
Imperial connections	Pipe 1 1/2" or thread 2 "

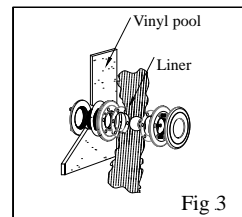

### 4 .-SPARE PARTS LIST :

POS .	CODE	PRODUCT DESCRIPTION
1	01050184	Face ring
2	89130106	Assembly eyeball
3	01050187	Body GB50
3	01050218	Body SB1.5"
4	01014172	Nut and eyeball regulator

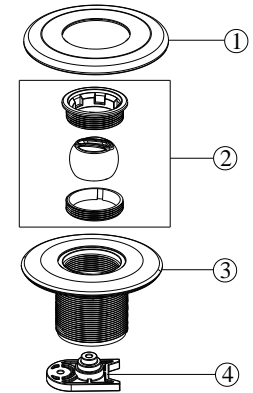

EM4411(A/E)

POS .	CODE	PRODUCT DESCRIPTION
1	01050184	Facering
2	03012115	Inlet cap
3	01050190	Screws M5x14
4	02010280	Ring
5	03012116	Screws M3.8x9.5
6	89130106	Liner gaskets
7	89130108	Body GB50
7	89130109	Body BS1.5"
8	01014172	Nut and Eyeball regulator

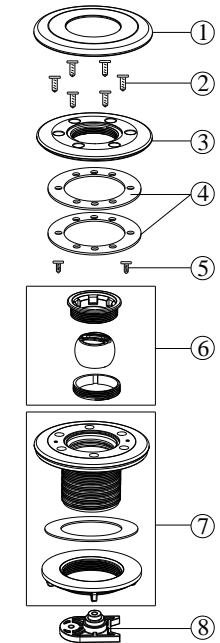

EM4412(A/E)