



# EMAUX P50 Plastic Spa Light

## B) INSTALLATION

- 1) Punch or drill a hole (Diameter = 62mm) in the desired location on the pool wall, see Figure 1. Be sure the top of the hole be at least 18 inches below the water level.
- 2) Put a O-ring on the pool wall and then feed the cord through the hole.
- 3) Use the nut provided to fix the underwater light on the pool wall, as shown in Figure 2.

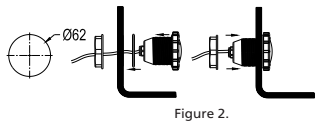

Figure 2.

- 4) Feed cord to junction box, strip 6 inches of the outer cord jacket to expose the insulation wires and make the wire connection to the junction box.
- 5) Secure the junction box cover in place.
- 6) Before operating the light

for more than 10 seconds, fill the pool with water until the underwater light is completely submerged in water. To check for proper operation, turn on main switch or circuit breaker as well as the switch that operates the underwater light itself.

**⚠ WARNING**

A) Never operate this Underwater Light for more than 10 seconds unless it is totally submerged in water. Without total submersion, the light assembly will get extremely hot, which may result in serious injury to pool users, installers, or damage to property.

B) Be sure power is off before installing or removing lamp. Allow lamp to cool before relamping. This light fixture uses a Halogen Quartz lamp. Do Not touch lamp with bare hand, this may severely reduce its life. Use the plastic furnished with the replacement lamp to eliminate finger prints from getting on lamp.

## Repair Parts list for Plastic Spa Light

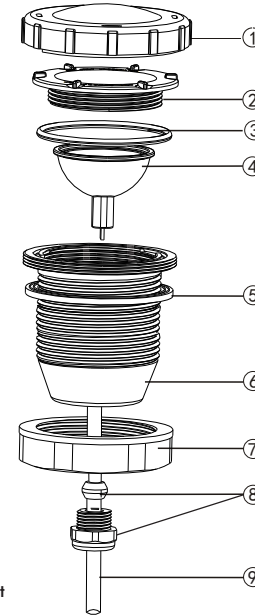

Figure 3 – Repair Parts Illustration for Plastic Spa Light

### Repair Parts list for Plastic Spa Light

Reference Number	Description	Part Number	Quantity
1	UL-P50 Lights Colour lens (Red/Green/Blue)	01221001	3
1	LED-P50 Plastic Lights Lens	01221001	1
2	Inside Covers for UL-P50 Lights	01041019	1
2	Inside Covers for LED-P50 Lights	01041019	1
3	O-Ring	02021010	1
4	Halogen lamp MR16 AC 12V/20W	04011001	1
4	LED-P50 Halogen lamp(Automatic Colour-Changing)12V/1W	04011016	1
4	LED-P50 Halogen lamp(White Colour Only)12V/1W	04011015	1
5	O-ring for Encasing	02021000	2
6	UL-P50 Lights Encasing Set	89041101	1
6	LED-P50 Light Encasing Set	89041101	1
7	Nut	01021007	1
8	Connector with Gasket for Cable	89041102	1
9	UL-P50 Lights Cable 1.5M	04013001	1
9	LED-P50 Lights Cable 1.5M	04013001	1